

600-660 Elizabeth Street Redfern



What is the site?

- 600-660 Elizabeth Street Redfern
- 1.1 hectares in area
- Bounded by Elizabeth, Kettle, Walker and Phillip Streets

What is Communities Plus?

- Communities Plus is a \$22 billion program to redevelop social housing sites and provide 23,000 new and replacement social housing dwellings, 500 affordable housing dwellings and 40,000 new private dwellings
- The site will be renewed as part of the Communities Plus Build-to-Rent program
- NSW Government will retain ownership of the land

Well connected with nearby facilities

Communities Plus



Walking distance to Redfern Station and future Waterloo Metro



Excellent access to local buses, walking and bike routes



Many local support services and facilities, close to jobs, education and childcare



Opposite Redfern Park and Oval for recreation and outlook



Variety of shops within the local neighbourhood



LEGEND



Community



Education



Health



Recreation



Shopping

Features of a new design – buildings

Communities Plus

KEY ELEMENTS

A new mixed community with around 500 new homes

Up to 35% social and affordable housing

Over 90% of the site will be nine storeys or less

Improved and expanded public plaza on Kettle Street

Improved and expanded garden on Phillip Street

New shops, cafes and community space

Landscaped areas

15-19 storeys
(one building)

6-9 storeys

5-6 storeys

Indicative subject to rezoning

Redfern Park



Active retail plaza



6-9 storeys along Elizabeth Street facing Redfern Oval



No shadow on Redfern Park beyond 10am



Communal garden on Phillip Street

Kettle Street

Elizabeth Street

Walker Street

Phillip Street

Single tower (15-19 storeys) on Kettle/Walker Street Corner

5-6 storeys along Walker Street for a local neighbourhood feel

Optimised sun access to Waterloo Conservation Area

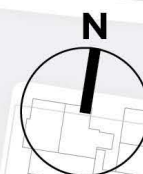

Features of a new design – landscape

Communities Plus



New public retail plaza on Kettle Street connected to local bike and walking routes



Green roof tops and central outdoor space for new residents



Public art reflecting the local culture and history



More street trees and improved footpaths



Communal garden on Phillip Street to transition to the heritage area

