

5.1.4 Staging strategy

An indicative staging strategy for the Paint Shop Sub-Precinct has been prepared as part of the Urban Design Report (refer to **Appendix C**). It is noted that the staging strategy is subject to changing market demand and further detailed logistical considerations during the delivery of the Urban Design Framework and may need to be revised during subsequent processes.

Stage 1: CME and Science Building

The initial stage (as illustrated at **Figure 18**) will be the revitalisation of the heritage listed the Chief Mechanical Engineer’s Building and the Science Lab. Site access will be available via the existing service road off Little Eveleigh Street with a lay down area available adjacent. Landscape works around the Chief Mechanical Engineer’s Building and will be carried out concurrently as part of Stage 3.

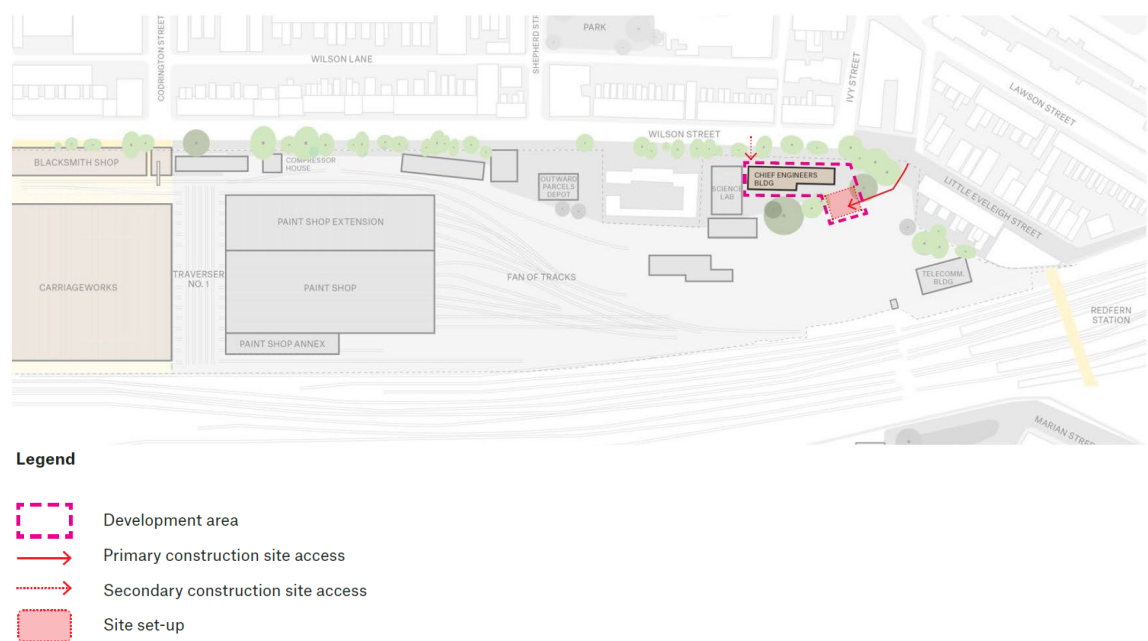

Figure 18. Stage 1: CME and Science Building

Source: Bates Smart

Stage 2: Wilson Street

Stage 2 (as illustrated at **Figure 19**) will involve development along the western end of Wilson Street will be constructed, including commercial building (E1) and a mixed use residential building (E2), both with retail uses on the lower floors. Temporary works will be carried out to the existing frame of the Suburban Car Workshop, with landscaping works also delivered as part of this stage.

Site access during construction will be from Wilson Street and from Carriageworks Way, with a lay down area on the lower level with measures intended in place to minimise disruption to Carriageworks and the Saturday Markets including maintaining vehicle access to No.1 Traverser. Landscaping immediately adjacent to the buildings will be completed as depicted.

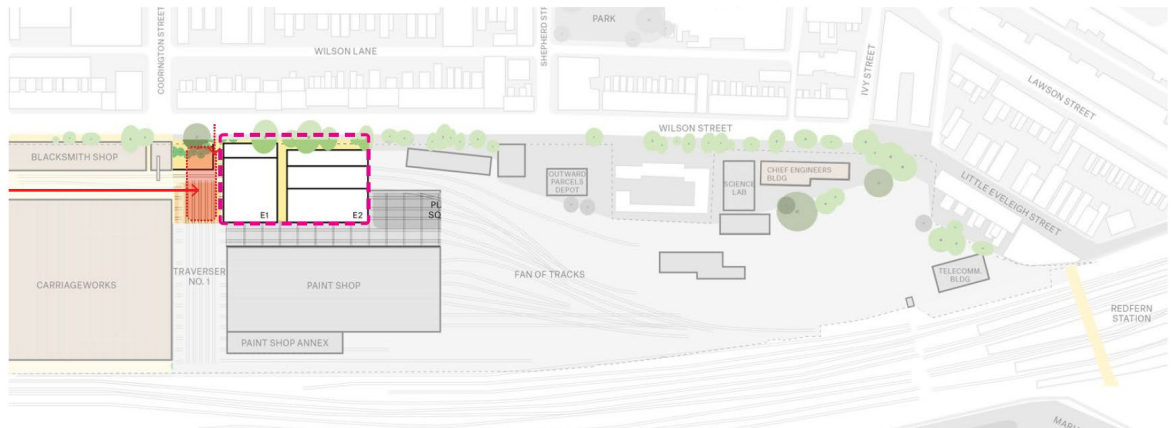

Legend

- Development area
- Primary construction site access
- - - - -> Secondary construction site access
- Site set-up

Figure 19. Stage 2: Wilson Street Development

Source: Bates Smart

Stage 3: Eastern end

Stage 3 (as illustrated at **Figure 20**) will focus on the delivery of the eastern part of the Paint Shop Sub-Precinct. Site access will be granted in the location of the current service road. Development L1 will act as the central lay down area for the duration of this stage. Landscape works will include delivery of the new Eastern Park, the landscape settings around the 3 heritage buildings (Science Lab, CME, Telecommunications building), as well as a new connection to Platform 1 and the new southern concourse of Redfern Station, linking the site with the wider context south.

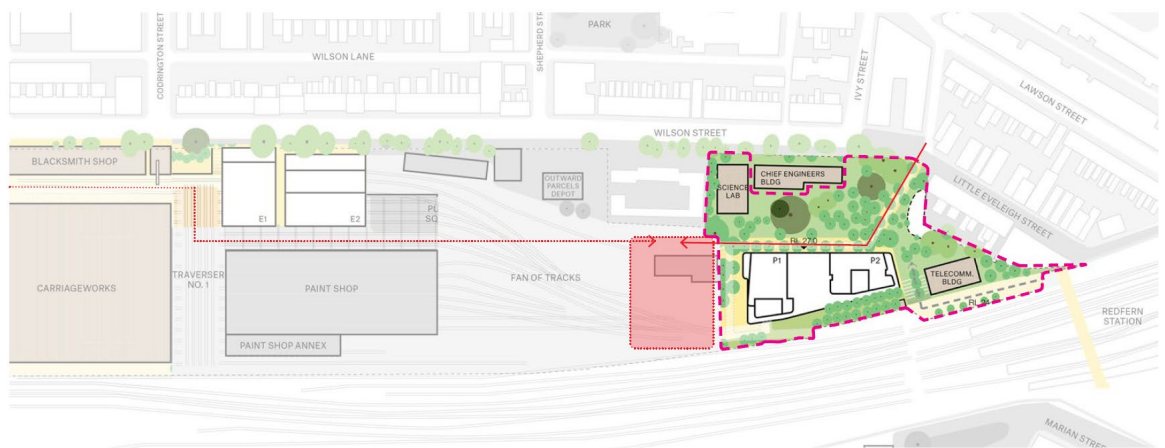

Legend

- Development area
- Primary construction site access
- - - - -> Secondary construction site access
- Site set-up

Figure 20. Stage 3: Eastern End

Source: Bates Smart

Stage 4: Paint Shop

Stage 4 (as illustrated at **Figure 21**) will see the completion of the Public Square which will include re-purpose works for the Paint-shop and over development. Site access will be granted initially from the western end, with access on the eastern end added once topography has been adjusted to the new landscape and Shepard Street extension into the site. Landscape works will include the Public Square and Pavilion, as well as the rail edge adjacent to the Paint Shop building.

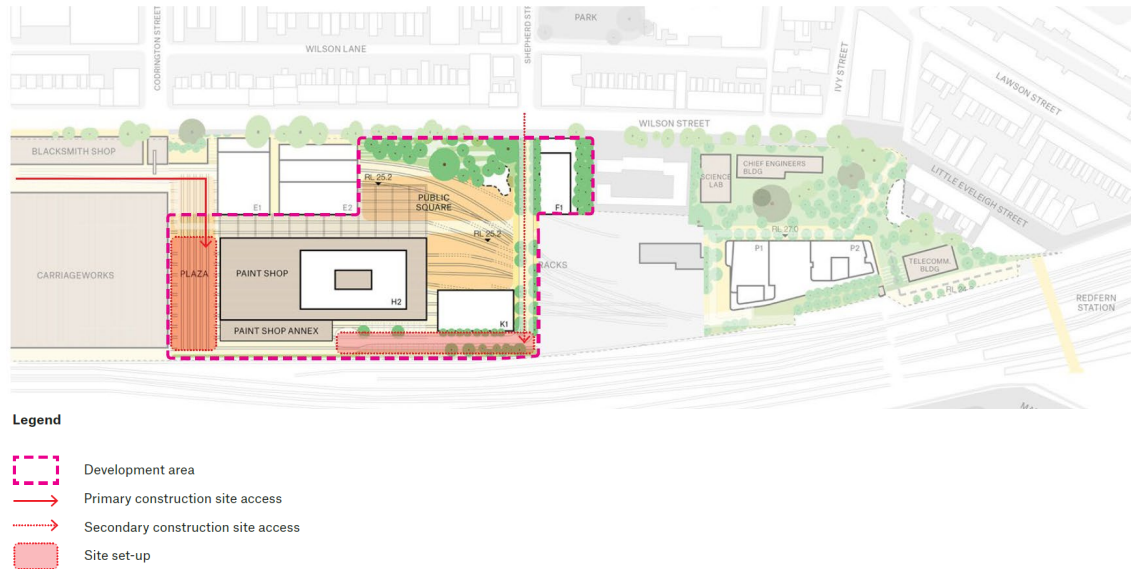

Figure 21. Stage 4: Paint Shop

Source: Bates Smart

Stage 5: Project completion

The final stage (as illustrated at **Figure 22**) will include Development Site K1 and L1. For site access, the newly established road network will be utilised, consolidated via Shepard Street extension. Land used for lay down areas will be reinstated to the final landscape design. Landscaping works will be limited to the land immediately adjacent to the new buildings to complete the overall delivery of the project.

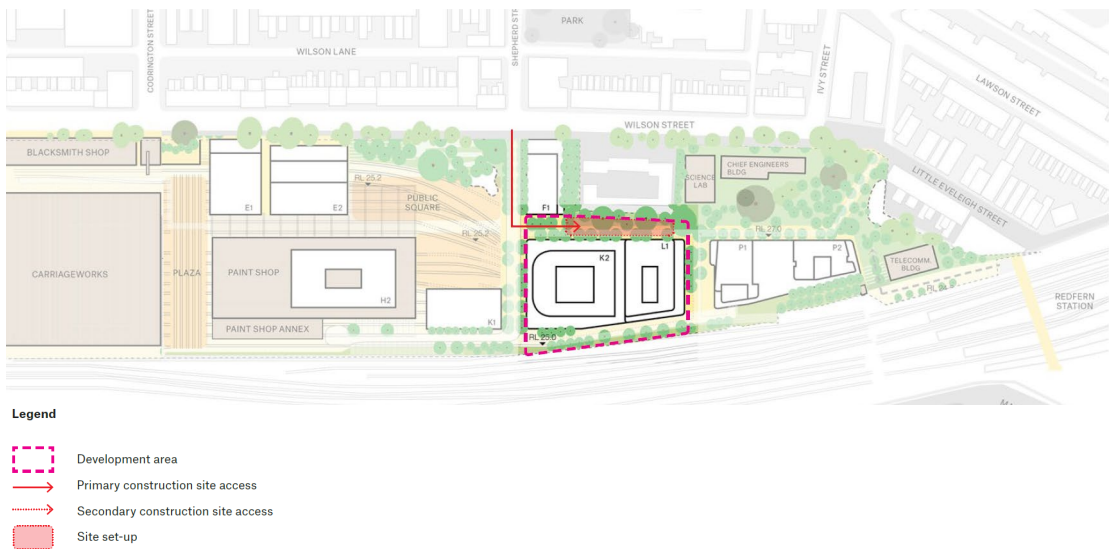

Figure 22. Stage 5: Project completion

Source: Bates Smart