

Research, Strategy & Corporate Planning Unit

Social & Economic Research

Overview

Current and future population growth
Floor Space & Employment Survey

city of villages

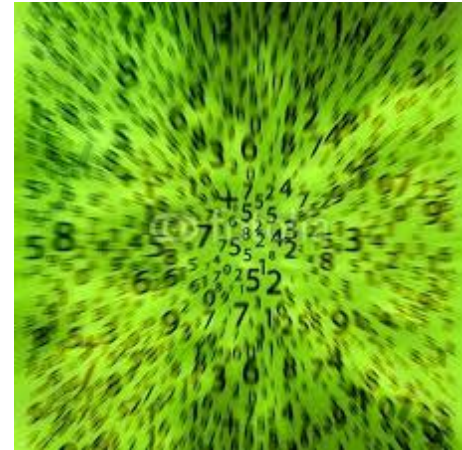

Strategic Databases

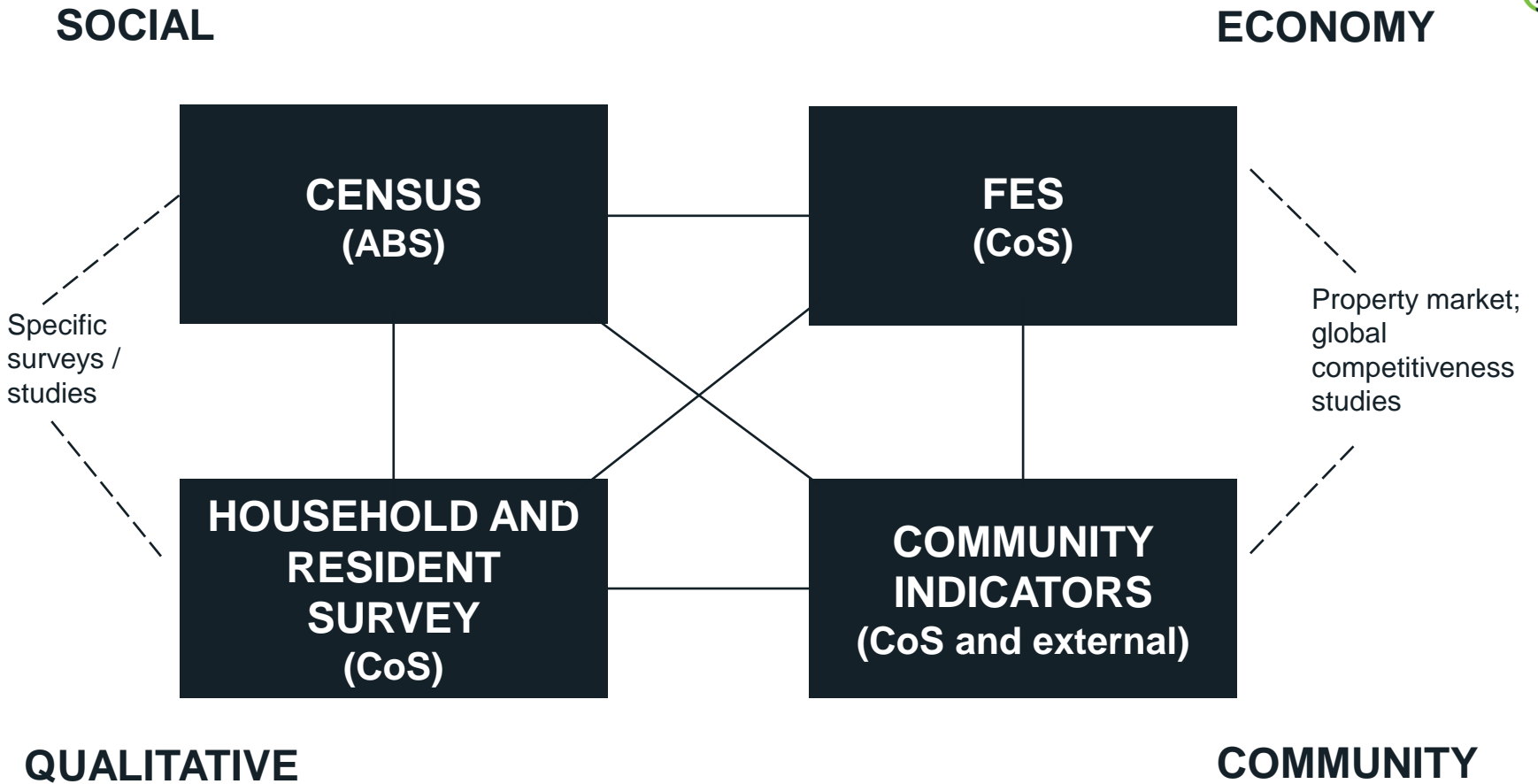

Current growth pressures

	2001 (‘000)	2006 (‘000)	2011 (‘000)	Change 2001-2011 (%)
Residents	129.8	165.6	183.5	42%
Workforce	359.7	385.4	437.7	22%
Visitor arrivals	3,337.3	3,645.2	4,247.0	27%

Future growth pressures 2011 - 2031

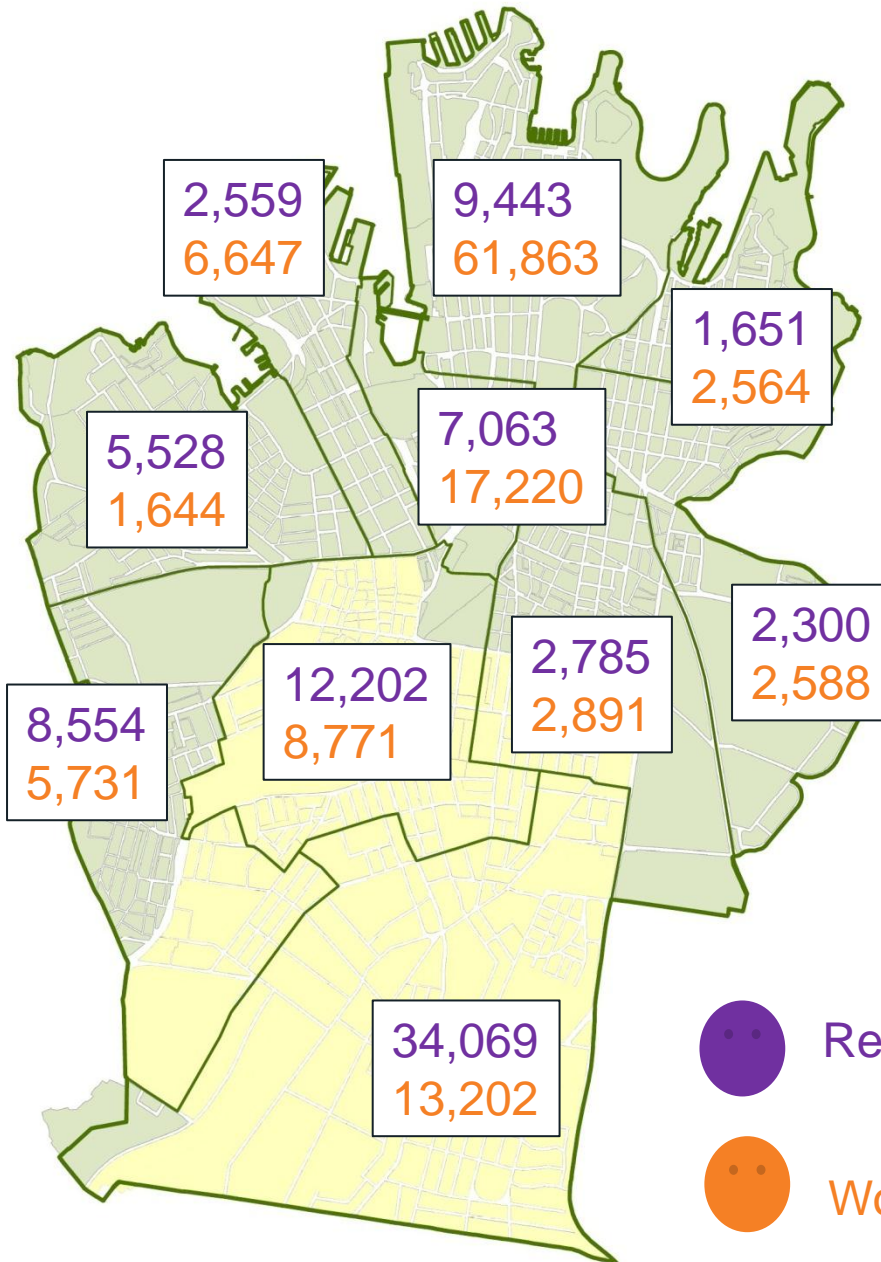

- Largest employment growth in CBD and Harbour
 - Workers will increase by 27.4%
- Largest resident growth in Green Square and City South
 - Residents will increase by over 34,000
- By 2031, LGA resident population expected to increase by over 85,000 to **269,646**

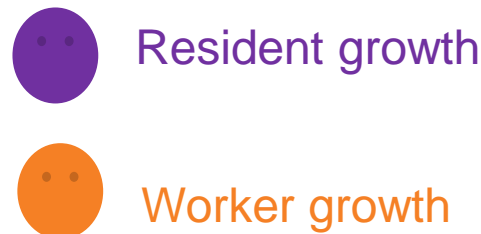

Short term resident growth pressures 2011-2021

Village area	2011	2016	2021	10 year change	% Change
Crown and Baptist Street	22,085	22,929	23,452	+1,367	6.2%
Green Square and City South	20,104	30,500	41,114	+21,010	104.5%
King Street	19,514	21,823	24,454	+4,940	25.3%
Redfern Street	21,160	25,593	29,087	+7,927	37.5%
Total	82,863	100,845	118,107	+35, 244	42.5%

“Green Square and City South” and “Redfern Street” combined
= 28,937 additional residents over 10 years

City of Sydney Research

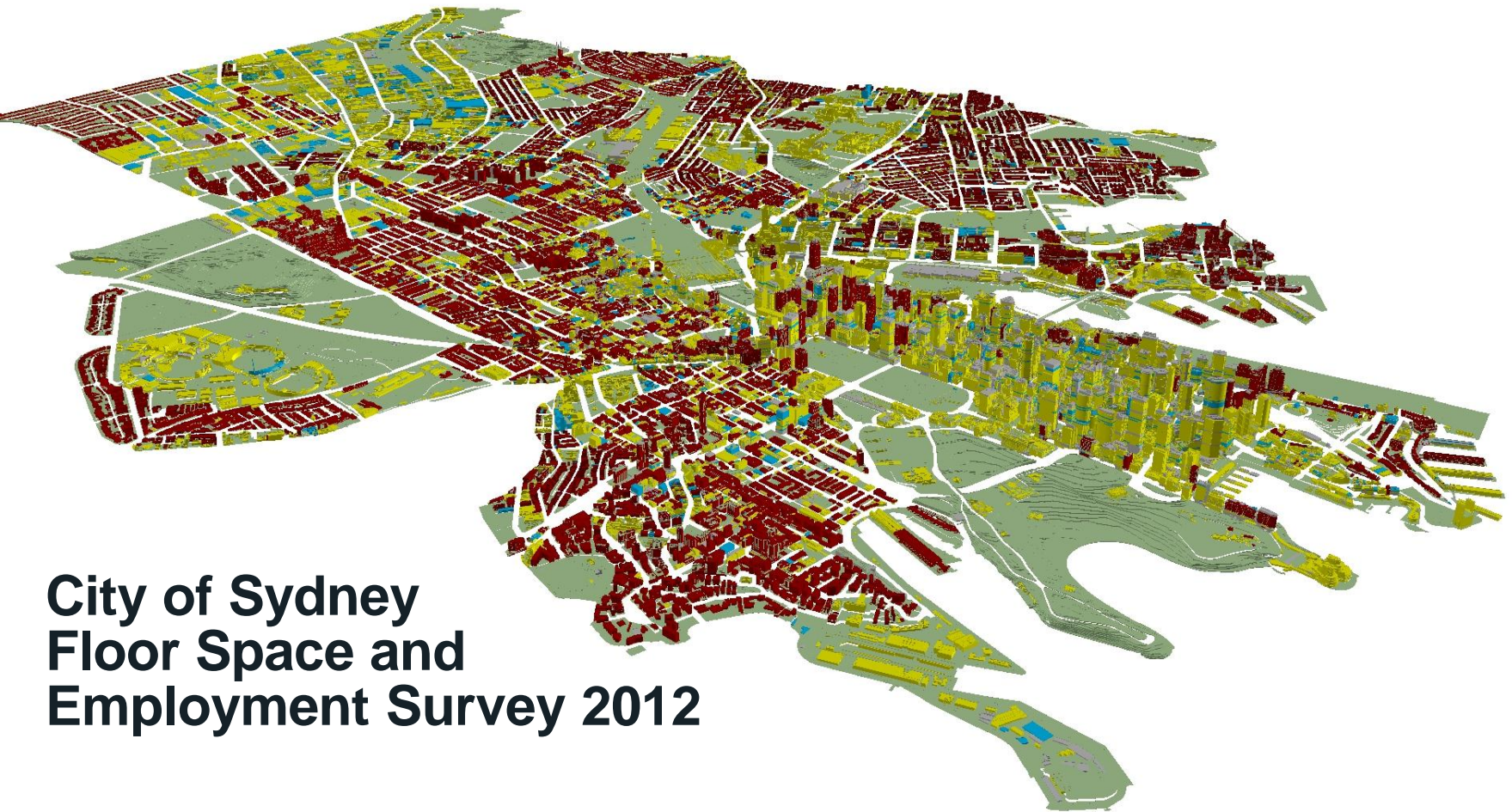

**City of Sydney
Floor Space and
Employment Survey 2012**

Floor Space and Employment Survey Background

- Survey every 5 years
- Visual inspection of all non-residential buildings
- Complete LGA census of all
 - Buildings
 - Businesses
 - Floor space
 - Employment

Collected Data

- **Building Data**

- Dwelling units, hotel rooms
- Number of levels
- Year built

- **Establishment Data**

- Business Name
- Industry (ANZSIC)
- Years of operation

- **Space Use Data**

- Description of space use
- Employment
- Capacity
- Floor areas calculated automatically

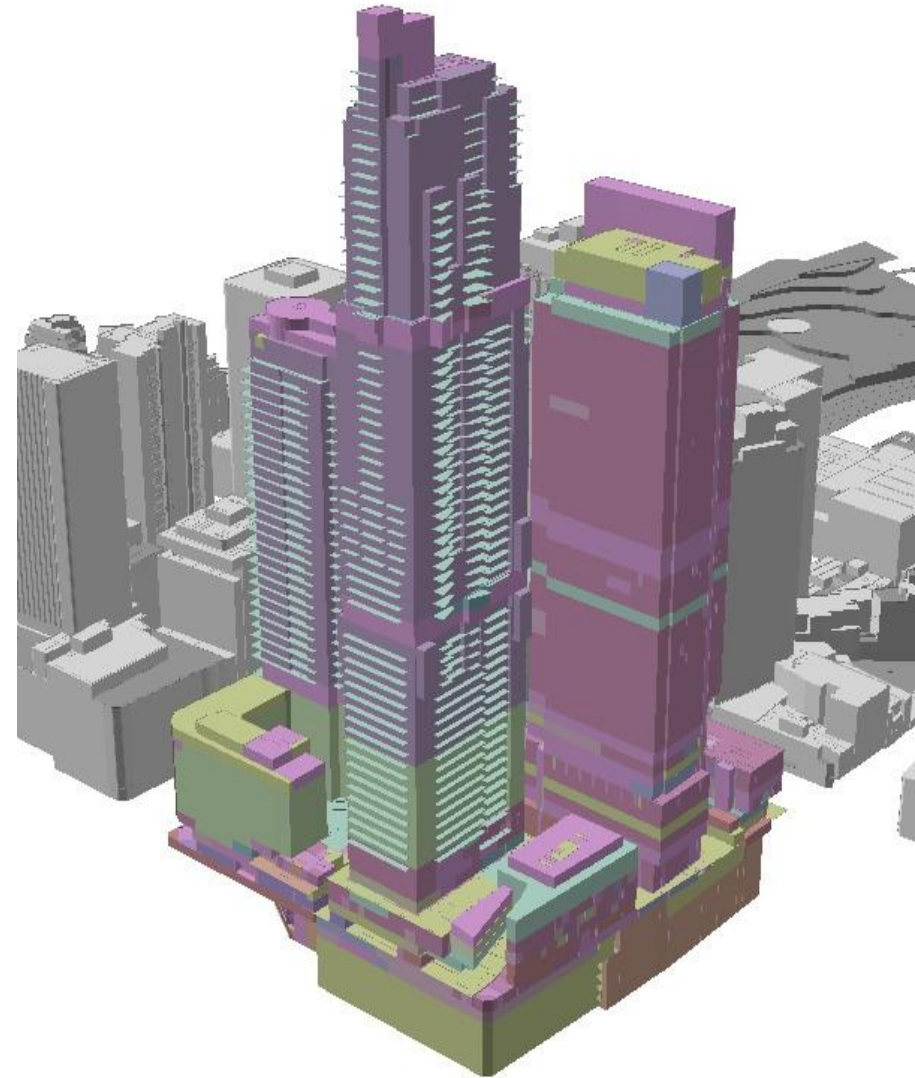

Floor Space And Employment Survey 2012 Overview

- 26,148 buildings
- 21,644 businesses (10.5% increase over 5 years)
 - 3,446 businesses located in Redfern LAC
- 437,727 workers (13.6% increase ~ up 52,306)
 - 47,541 workers located in Redfern LAC (20.3% increase ~ up 8,006)
- Work Space Ratios (WSR) have fallen again

Major Growth Sectors

Change between 2007 and 2012

- Professional and Business Services
 - +39.7% workers
- Food and Drink
 - +44.7% workers
- Higher Education and Research
 - +30.6% workers
- Creative Industries
 - +8.6% workers

Major Growth Sectors

Change between 2007 and 2012

Redfern LAC

- Professional and Business Services
 - +64.0% workers
- Creative Industries
 - +39.2% workers
- Retail and Personal Services
 - +43.0% workers
- Higher Education and Research
 - +26.9% workers

Employment Mix

Top Six Industries by Village

- Villages characterised by unique employment mix
- Finance & Financial Services is still the predominant industry (22% of LGA workforce)
- 63% of LGA workforce located in the CBD

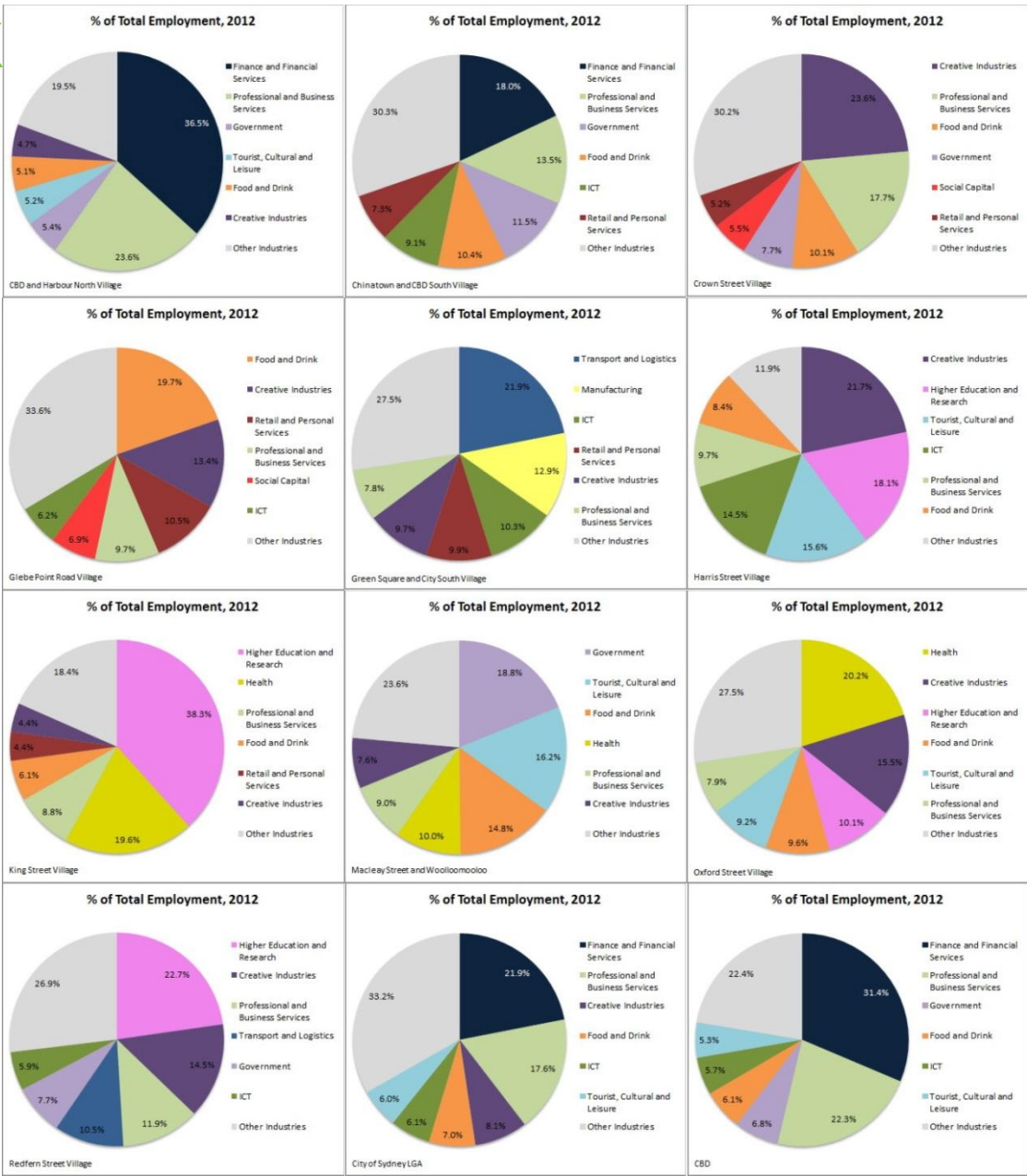

Employment Mix

Top Six Industries 2007 vs. 2012 Redfern LAC

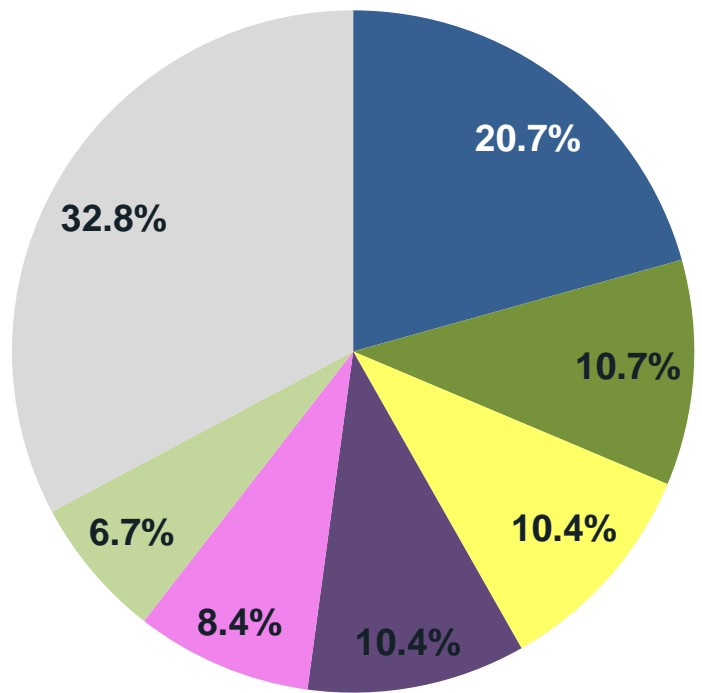

2007

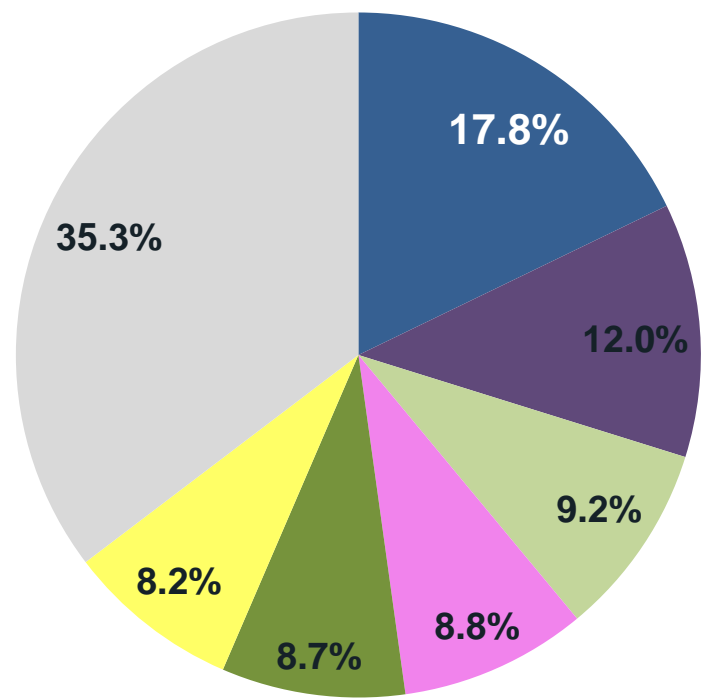

2012

- Transport and Logistics
- Creative Industries
- Professional and Business Services
- Higher Education and Research
- ICT
- Manufacturing
- Other

Business Clusters

ICT (Digital) Industries

- 1,016 ICT Businesses (4.6% of total)
- 26,645 ICT Workers (6.1% of total)
- Majority of businesses are located in the CBD
- Clusters emerging in
 - Pyrmont
 - Wattle Street
 - Surry Hills
 - Oxford Street
 - Australian Technology Park

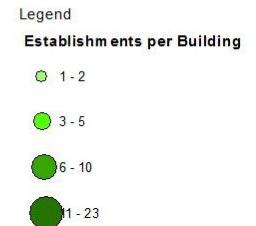
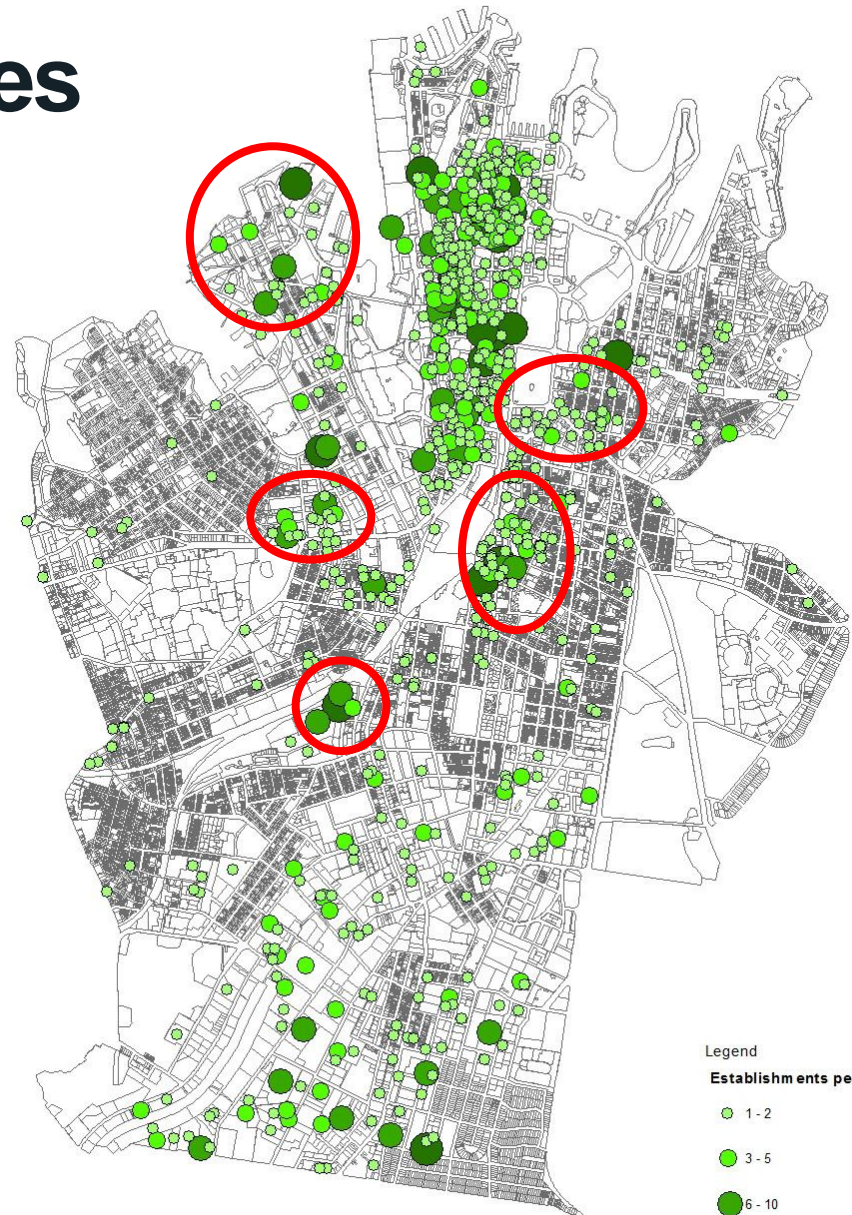

Business Size in Redfern LAC

Proportion of Businesses and Employment

Size	Businesses	Employment	Businesses (%)	Employment (%)	Average employment per business
1-4	1,536	3,859	44.9%	8.2%	2.5
5-19	1,426	12,674	41.7%	26.8%	8.9
20-199	432	21,339	12.6%	45.1%	49.4
200+	26	9,396	0.8%	19.9%	361.4
Total	3,420	47,268	100.0%	100.0%	13.8

86.6% of businesses in Redfern LAC employ less than 20 workers, representing 35% of the total Redfern LAC workforce

Office Space Use in Redfern LAC

Work Space Ratios

	2007			2012		
Office Type	Internal Area	Workers	WSR	Internal Area	Workers	WSR
Partitioned Office	134,376	6,502	20.7	178,723	9,422	19.0
Open Plan Office	472,833	19,952	23.7	439,204	21,226	20.7
Total	607,209	26,454	23.0	617,927	30,648	20.2

Floor Space And Employment Survey Data Uses - Internal

- Economic Strategy and Action Plans
- Operational Service Delivery
- Residential and Commercial Forecasting
- Capacity Study
- Decentralised Water Master Plan
- Energy Efficiency Master Plan
- Light Rail / George Street Benchmarking

For more information

www.cityofsydney.nsw.gov.au/learn

www.abs.gov.au

Home Learn

- ▶ About Sydney
- ▶ Research and statistics
- ▶ Historians and archivists
- ▶ Search our collections
- ▶ Sydney's history

Learn

About Sydney

▶ Read more



Our global city

▶ Read more



Research and statistics

▶ Read more



Historians and archivists

▶ Read more

